

PART# 76-20508SB



TOOLS NEEDED

19mm SOCKET
18mm SOCKET
3/4" SOCKET
9/16" SOCKET
7/16" SOCKET
RATCHET
TORQUE WRENCH

QTY DESCRIPTION

2	STAINLESS STEP BARS(1 DRIVER SIDE;1 PASSENGER SIDE)
2	FRONT MOUNTING BRACKETS
2	REAR MOUNTING BRACKETS
4	1/2"x2" HEX BOLTS
8	1/2" FLAT WASHERS
8	1/2" LOCK WASHERS
4	M12-1.75"x120mm HEX BOLTS
4	1/4"-20x1" SELF DRILLING SCREW
4	3/8"x1" BOLTS
4	3/8" NUTS
4	3/8" LOCK WASHERS

STEPS INSTALLATION

- 1 CHECK CONTENTS OF BOX FOR DAMAGE OR MISSING ITEMS.
- 2 BOLT MOUNTING BRACKETS TO STEP BAR(HAND TIGHT)
- 3 REMOVE BOLTS FROM BODY MOUNTS UNDER THE CAB. POSITION STEP BAR ASSEMBLY TO BODY MOUNTS AND INSTALL WITH HARDWARE PROVIDED
- 4 TIGHTEN + TORQUE BODY MOUNT BOLTS TO 55 FT/LBS TIGHTEN + TORQUE 1/2" STEP BAR BOLTS TO 65 FT/LBS

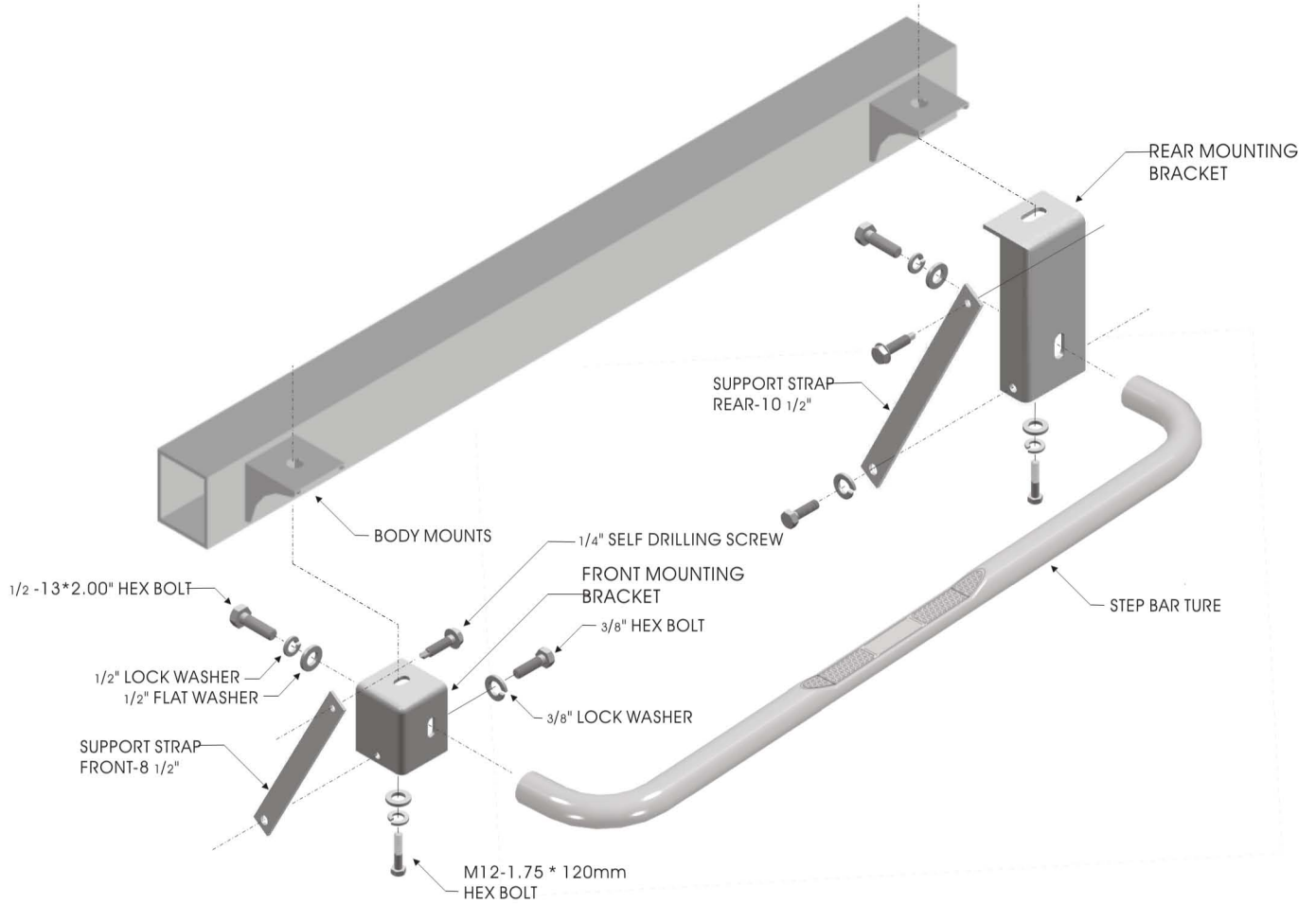

ASSEMBLY & INSTALLATION VIEW DRIVER SIDE - PASSENGER OPPOSITE